

ENGINEERED FILL NOTE:
 FILL USED FOR RAISING SITE GRADE OR FOR REPLACEMENT OF MATERIAL THAT IS UNDERCUT SHOULD BE UNIFORMLY COMPACTED IN THIN LIFTS TO AT LEAST 95% OF THE STANDARD PROCTOR MAXIMUM DRY DENSITY (ASTM D 998). IN ADDITION, AT LEAST THE UPPER 18 INCHES OF SUBGRADE FILL BENEATH PAVEMENTS AND FLOOR SLABS AND 24 INCHES BELOW PAVEMENTS SUBJECT TO TRUCK TRAFFIC SHOULD BE COMPACTED TO 100% OF THE SAME SPECIFICATION.
 (FOR ADDITIONAL INFORMATION REFER TO THE REPORT OF PRELIMINARY GEOTECHNICAL EXPLORATION PREPARED BY LAW ENGINEERING AND ENVIRONMENTAL SERVICES, INC. DATED JUNE 21, 2002.)

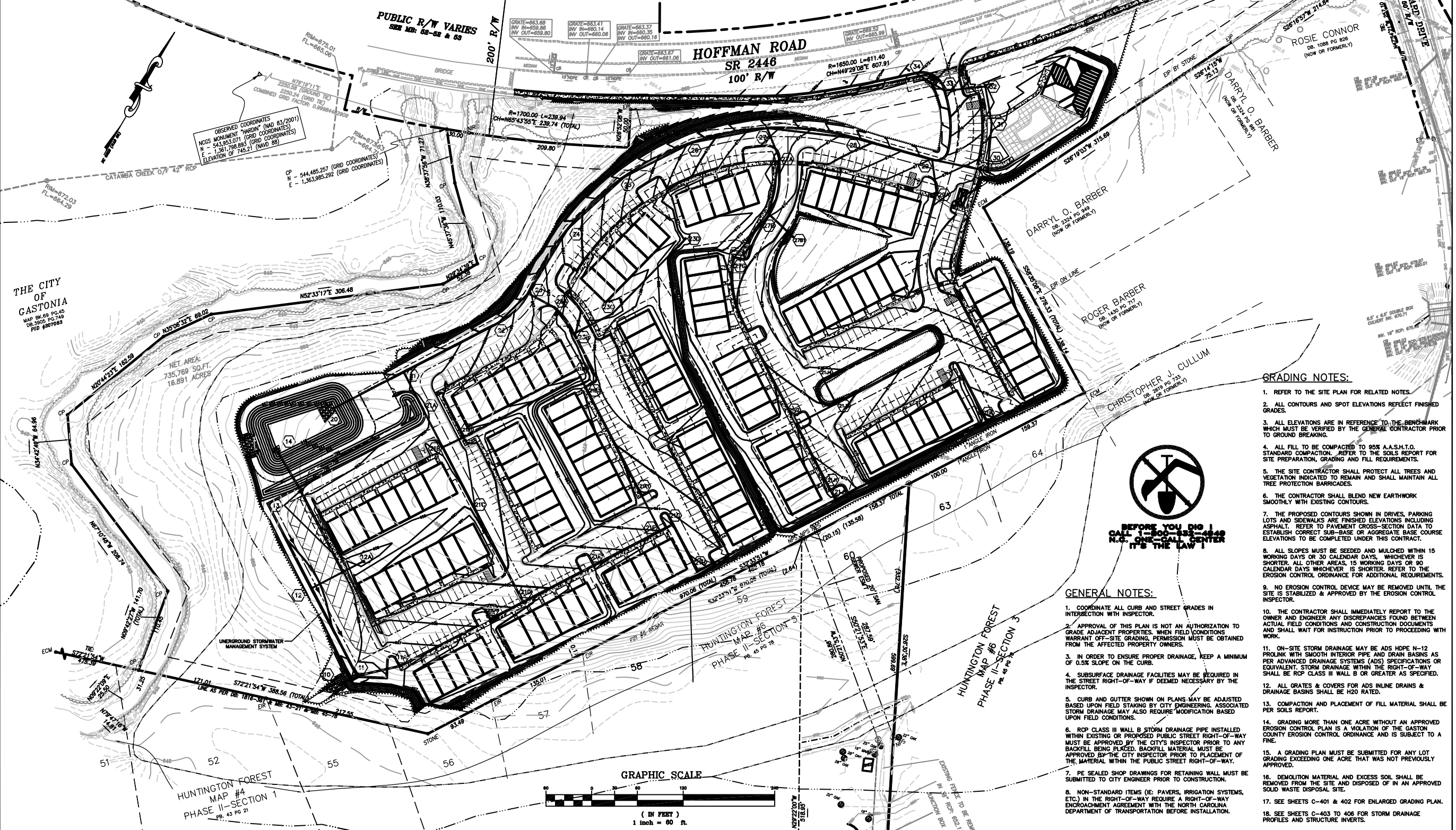

- GRADING NOTES:**
- REFER TO THE SITE PLAN FOR RELATED NOTES.
 - ALL CONTOURS AND SPOT ELEVATIONS REFLECT FINISHED GRADES.
 - ALL ELEVATIONS ARE IN REFERENCE TO THE BENCHMARK WHICH MUST BE VERIFIED BY THE GENERAL CONTRACTOR PRIOR TO GROUND BREAKING.
 - ALL FILL TO BE COMPACTED TO 95% A.A.S.H.T.O. STANDARD COMPACTION. REFER TO THE SOILS REPORT FOR SITE PREPARATION, GRADING AND FILL REQUIREMENTS.
 - THE SITE CONTRACTOR SHALL PROTECT ALL TREES AND VEGETATION INDICATED TO REMAIN AND SHALL MAINTAIN ALL TREE PROTECTION BARRICADES.
 - THE CONTRACTOR SHALL BLEND NEW EARTHWORK SMOOTHLY WITH EXISTING CONTOURS.
 - THE PROPOSED CONTOURS SHOWN IN DRIVES, PARKING LOTS AND SIDEWALKS ARE FINISHED ELEVATIONS INCLUDING ASPHALT. REFER TO PAVEMENT CROSS-SECTION DATA TO ESTABLISH CORRECT SUB-BASE OR AGGREGATE BASE COURSE ELEVATIONS TO BE COMPLETED UNDER THIS CONTRACT.
 - ALL SLOPES MUST BE SEEDED AND MULCHED WITHIN 15 WORKING DAYS OR 30 CALENDAR DAYS, WHICHEVER IS SHORTER. ALL OTHER AREAS, 15 WORKING DAYS OR 90 CALENDAR DAYS WHICHEVER IS SHORTER. REFER TO THE EROSION CONTROL ORDINANCE FOR ADDITIONAL REQUIREMENTS.
 - NO EROSION CONTROL DEVICE MAY BE REMOVED UNTIL THE SITE IS STABILIZED & APPROVED BY THE EROSION CONTROL INSPECTOR.
 - THE CONTRACTOR SHALL IMMEDIATELY REPORT TO THE OWNER AND ENGINEER ANY DISCREPANCIES FOUND BETWEEN ACTUAL FIELD CONDITIONS AND CONSTRUCTION DOCUMENTS AND SHALL WAIT FOR INSTRUCTION PRIOR TO PROCEEDING WITH WORK.
 - ON-SITE STORM DRAINAGE MAY BE ADS HOPE N-12 PROLINK WITH SMOOTH INTERIOR PIPE AND DRAIN BASINS AS PER ADVANCED DRAINAGE SYSTEMS (ADS) SPECIFICATIONS OR EQUIVALENT. STORM DRAINAGE WITHIN THE RIGHT-OF-WAY SHALL BE RCP CLASS III WALL B OR GREATER AS SPECIFIED.
 - ALL GRATES & COVERS FOR ADS INLINE DRAINS & DRAINAGE BASINS SHALL BE H20 RATED.
 - COMPACTION AND PLACEMENT OF FILL MATERIAL SHALL BE PER SOILS REPORT.
 - GRADING MORE THAN ONE ACRE WITHOUT AN APPROVED EROSION CONTROL PLAN IS A VIOLATION OF THE GASTON COUNTY EROSION CONTROL ORDINANCE AND IS SUBJECT TO A FINE.
 - A GRADING PLAN MUST BE SUBMITTED FOR ANY LOT GRADING EXCEEDING ONE ACRE THAT WAS NOT PREVIOUSLY APPROVED.
 - DEMOLITION MATERIAL AND EXCESS SOIL SHALL BE REMOVED FROM THE SITE AND DISPOSED OF IN AN APPROVED SOLID WASTE DISPOSAL SITE.
 - SEE SHEETS C-401 & 402 FOR ENLARGED GRADING PLAN.
 - SEE SHEETS C-403 TO 406 FOR STORM DRAINAGE PROFILES AND STRUCTURE INVERTS.

- GENERAL NOTES:**
- COORDINATE ALL CURB AND STREET GRADES IN INTERSECTION WITH INSPECTOR.
 - APPROVAL OF THIS PLAN IS NOT AN AUTHORIZATION TO GRADE ADJACENT PROPERTIES. WHEN FIELD CONDITIONS WARRANT OFF-SITE GRADING, PERMISSION MUST BE OBTAINED FROM THE AFFECTED PROPERTY OWNERS.
 - IN ORDER TO ENSURE PROPER DRAINAGE, KEEP A MINIMUM OF 0.5% SLOPE ON THE CURB.
 - SUBSURFACE DRAINAGE FACILITIES MAY BE REQUIRED IN THE STREET RIGHT-OF-WAY IF DEEMED NECESSARY BY THE INSPECTOR.
 - CURB AND GUTTER SHOWN ON PLANS MAY BE ADJUSTED BASED UPON FIELD STAKING BY CITY ENGINEERING. ASSOCIATED STORM DRAINAGE MAY ALSO REQUIRE MODIFICATION BASED UPON FIELD CONDITIONS.
 - RCP CLASS III WALL B STORM DRAINAGE PIPE INSTALLED WITHIN EXISTING OR PROPOSED PUBLIC STREET RIGHT-OF-WAY MUST BE APPROVED BY THE CITY'S INSPECTOR PRIOR TO ANY BACKFILL BEING PLACED. BACKFILL MATERIAL MUST BE APPROVED BY THE CITY INSPECTOR PRIOR TO PLACEMENT OF THE MATERIAL WITHIN THE PUBLIC STREET RIGHT-OF-WAY.
 - PE SEALED SHOP DRAWINGS FOR RETAINING WALL MUST BE SUBMITTED TO CITY ENGINEER PRIOR TO CONSTRUCTION.
 - NON-STANDARD ITEMS (E: PAVERS, IRRIGATION SYSTEMS, ETC.) IN THE RIGHT-OF-WAY REQUIRE A RIGHT-OF-WAY ENCROACHMENT AGREEMENT WITH THE NORTH CAROLINA DEPARTMENT OF TRANSPORTATION BEFORE INSTALLATION.

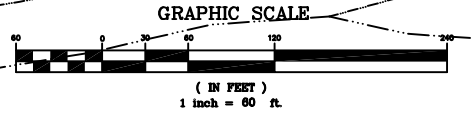
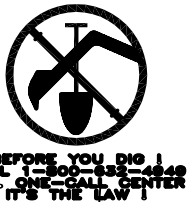

DATE	DESCRIPTION
06/08/06	PLAN SUBMISSION
01/31/07	PLAN REVISIONS PER CLIENT COMMENTS AND THE CITY OF GASTONIA COMMENTS & RED-LINES
05/02/07	PLAN REVISIONS PER THE CITY OF GASTONIA COMMENTS & RED-LINES
07/27/07	PLAN SUBMISSION
09/20/07	PLAN REVISIONS PER CITY OF GASTONIA
11/15/07	PLAN SUBMISSION

CLIENT:
 THE RESERVE AT CATAWBA CREEK, LLC.
 2857 WESTPORT ROAD
 CHARLOTTE, NORTH CAROLINA 28208
 (704) 399-4663
 CONTACT: MR. J. CLARK STEWART

MEADE GUNNELL
 Engineering & Surveying, P.C.
 806-A West Columbia Avenue
 Charlotte, NC 28202
 704-685-7280 704-685-7281 (fax)

DATE:
 JUNE 8, 2006

THE RESERVE AT CATAWBA CREEK
 THE CITY OF GASTONIA
 GASTON COUNTY, NORTH CAROLINA

OVERALL GRADING & STORM SEWER PLAN

JOB NUMBER: 850.20
SHEET NUMBER: C-400